

MICRO•SAL™ SMALL ANIMAL SALIVA COLLECTION SYSTEM, CATALOG # MRSAL-402

INSTRUCTIONS FOR SALIVA COLLECTION USING THE MICRO•SAL™ SMALL ANIMAL SALIVA COLLECTION SYSTEM

1. Do not allow the animal to eat or drink for at least 10 minutes before you start the collection process.
2. Review the detailed instructions on the Micro•SAL™ Small Animal Saliva Collection System insert below.
4. Open the package containing the Micro•SAL™ Small Animal Saliva Collection System and place the contents on a clean and dry surface. Follow the illustrated instructions below.

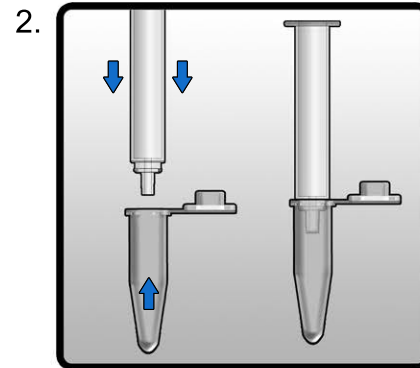
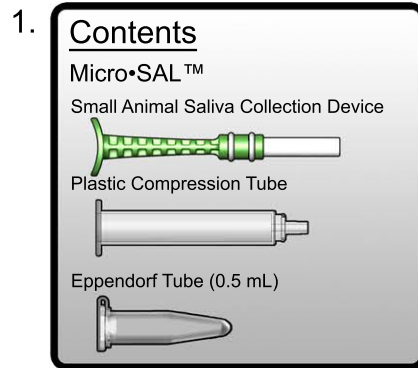

Attach the Eppendorf tube provided to the base of the Plastic Compression Tube firmly.

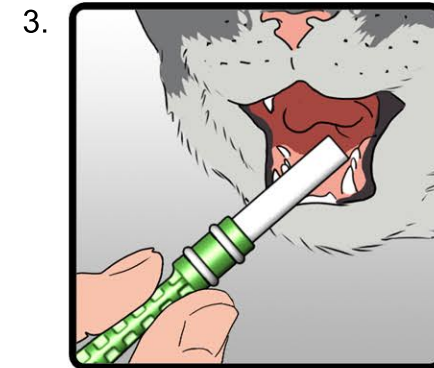

Place the tip end of the white absorbent collection pad of the Micro•SAL™ device into the mouth of the small animal where saliva pools, and collect until the pad is saturated.

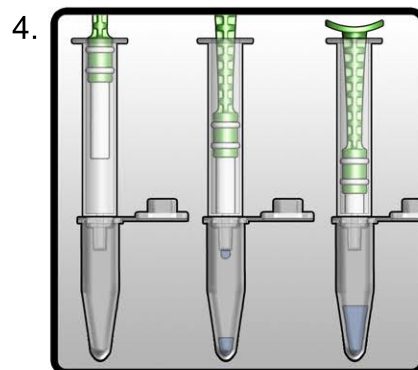

Place the white absorbent pad end into the Plastic Compression Tube holding the Micro•SAL™ device in an upright and vertical position and firmly push the plunger downwards to transfer saliva from the absorbent pad into the Eppendorf Tube. Push and hold for 15 seconds.

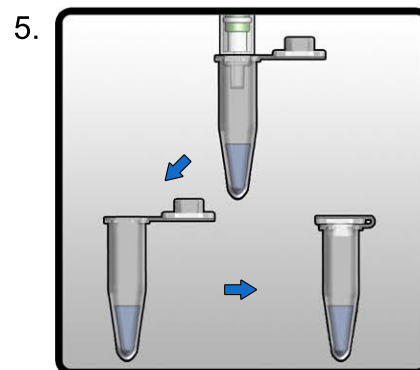

Gently remove the Eppendorf Tube from the end of the Plastic Compression Tube. Add preservative (not provided), if required, and close the lid on the tube tightly.

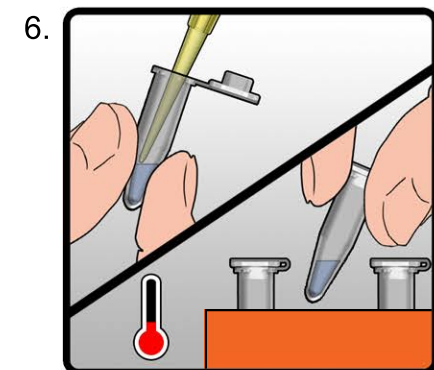

Process the collected sample immediately or store at refrigerated temperatures [depending upon the specific application] until required.