

Instructions for Use:

1. Do not eat, drink, smoke or chew gum for 10 minutes before providing your saliva sample.
2. Pool saliva in the mouth
3. Open the Sample Bottle containing the Stabilizing Rinse Solution provided and set down the Bottle and Cap on a flat surface.
4. Take the DNA-SAL™ device and place in the mouth with the Collection Teeth perpendicular to the inside of the cheek, towards the LOWER end of the inside of the cheek where the cheek meets the gum line.
5. Place a finger on the OUTSIDE of the cheek [to act as a resistance] while collecting the sample and rake the Collection Teeth along the inside of the cheek area back and forth for 30 seconds to collect a mixture of saliva and cellular material. NOTE: the Collection Area on the DNA-SAL™ Device does not need to be saturated as additional cells remain in the saliva in the mouth and will be collected by subsequent rinsing. Recommended minimum raking time is 30 seconds.
6. Remove the device from the mouth and hold in one hand.
7. Using the other hand, pour the contents of the Sample Bottle [2.5 mL of Stabilizing Rinse Solution] into the mouth and "swish" around for 10-15 seconds. DO NOT SWALLOW.

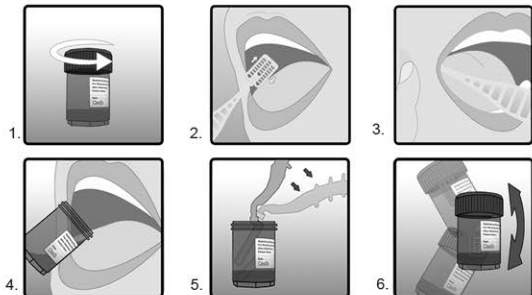

8. Pick up the Sample Bottle and expectorate ["spit"] as much of the Stabilizing Rinse Solution as possible back into the same Sample Bottle. The Stabilizing Rinse Solution is now enriched with saliva and epithelial cells containing DNA.
9. Holding the Sample Bottle firmly with one hand, insert the DNA-SAL™ Device with the Collection Area pointing downwards into the Sample Bottle and with the other hand SNAP OFF the head of the device in the neck of the Sample Bottle by bending backwards [as shown in Diagram 5 below] until the Collection Head of the DNA-SAL™ Device drops off and into the Sample Bottle.
10. Discard the Device Handle and screw the Cap of the Sample Bottle down tightly to secure the Sample.
11. Shake the Sample Bottle [now containing a mixture of Stabilizing Rinse Solution, saliva and cells] vigorously for 15 seconds to mix the Stabilizing Rinse Solution and Sample.
12. The Sample is now ready for immediate processing or for transportation to a laboratory where sample extraction may be performed.
13. In some kits a "Return Envelope" is provided for sample transportation purposes. If an envelope is provided, please use this to send the collected sample back to the appropriate return address.

Oasis
DIAGNOSTICS

15720 NE 31st Avenue
Vancouver, WA 98686 USA
Tel: 360.546.1563
Fax: 360.546.1581
Email: Info@4saliva.com

www.4saliva.com

DNA-SAL™
Salivary DNA Collection Device
Catalog Number DNAS - 102



Sample Bottle



DNA-SAL™ Device