

Accu•SAL™ ORAL FLUID COLLECTION SYSTEM, CATALOG # ACSL-201

INSTRUCTIONS FOR SALIVA COLLECTION USING THE ACCU•SAL™ ORAL FLUID COLLECTION SYSTEM

1. Do not eat, drink, smoke, or use oral hygiene products for at least 10 minutes before you start the collection process.
2. Review the detailed instructions on the Accu•SAL™ Oral Fluid Collection System insert below, particularly illustration 4, which shows the appearance of the Sample Volume Adequacy Indicator (SVAI) before and after sample collection.
3. After the five minutes have passed, open the package containing the Accu•SAL™ Oral Fluid Collection system, place the contents above on a clean, dry surface away from any potential hazards. Follow the illustrated instructions below.

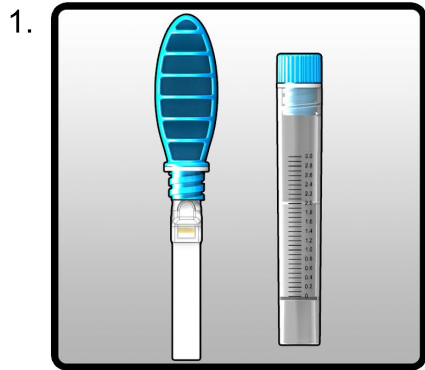

In preparation for oral fluid collection, place the contents above on a clean, dry surface away from any potential hazards which might contaminate components.

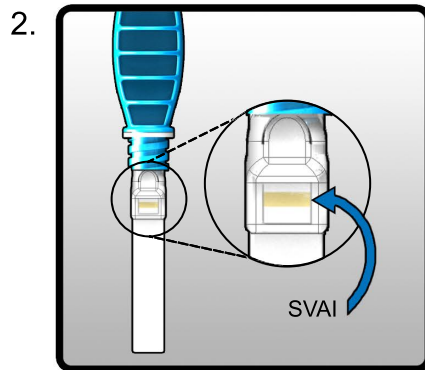

View the SVAI just beneath the handle, with the front of the handle facing you, by looking directly at the SVAI with the strip held at a slight angle away from you.

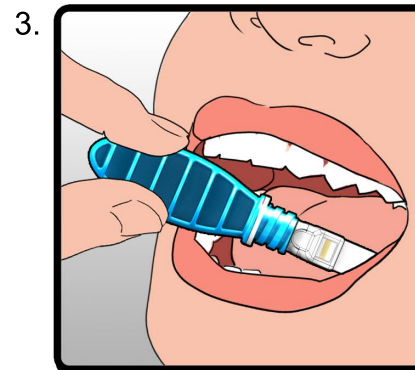

Pool saliva in the mouth while holding the Handle, place the Collection Strip in the mouth along the gum line or on top of the tongue. Allow the Collection Strip to absorb saliva until saturated.

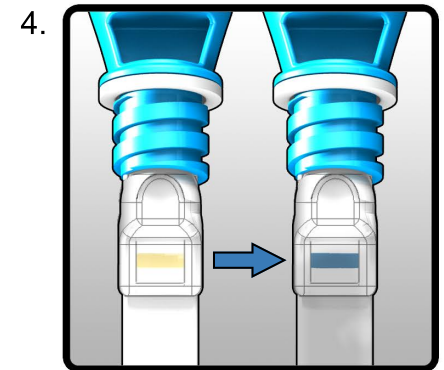

Remove the Collection Strip from the mouth every 15-20 seconds and continue collecting until the SVAI changes from yellow to blue (see above). Sample collection is now complete.

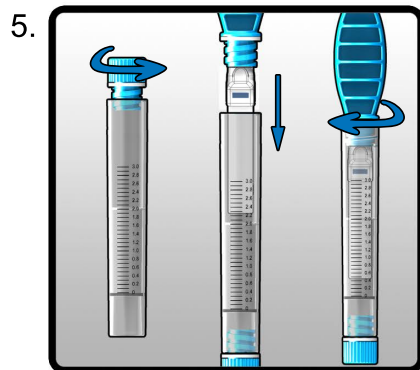

Remove the cap from the vial containing the solution. Place the saturated pad into the vial containing the clear solution, and screw the handle tightly onto the vial.

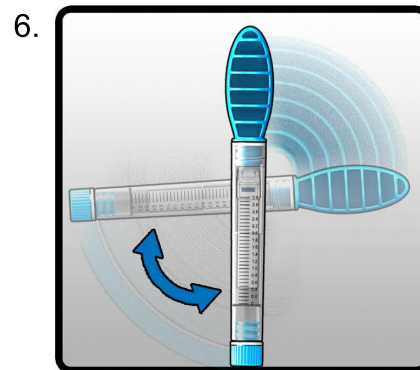

Invert vial 4-5 times. See Reference Sheet to identify saliva yield.

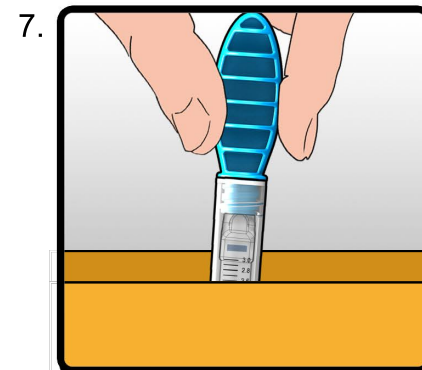

If the sample is to be analyzed at the point of collection, use validated protocol for downstream testing. Otherwise, prepare the sample for transportation to a laboratory using standard shipping methods for liquid samples.